

WT-60 & WT-125 Micro Torch Set Up

STEP 1

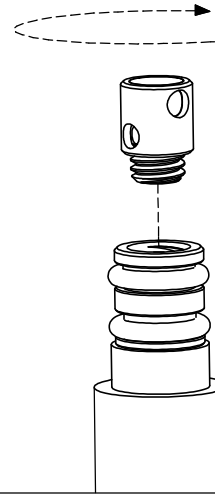

STEP 2

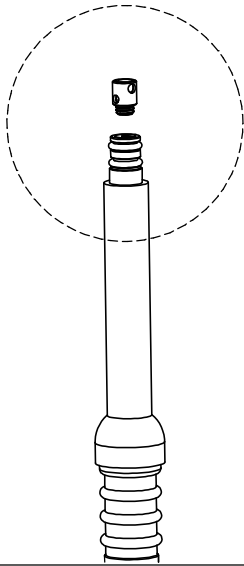
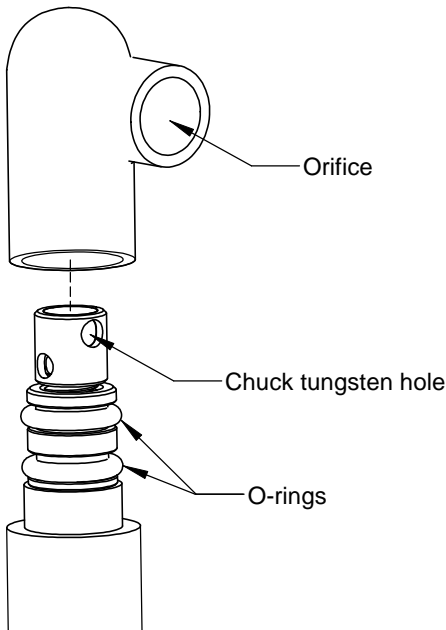

STEP 3

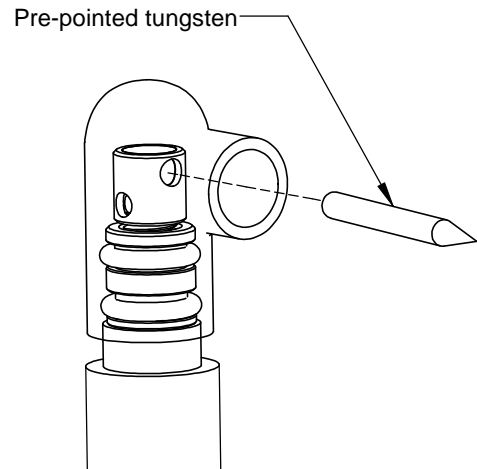

STEP 4

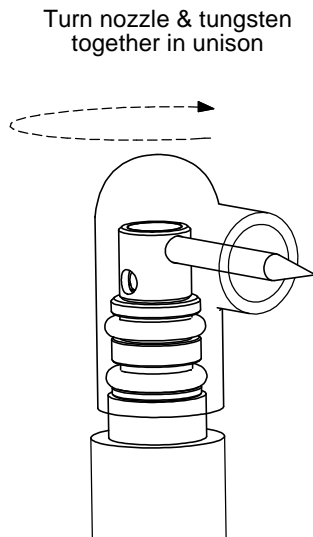

Tungsten Insertion

Step 1 - Screw tungsten chuck in end of torch body by turning clockwise until it stops, then reverse chuck 1/4 turn until chuck sleeve is loose

Step 2 - Slide glass nozzle onto o-rings of torch body and align gas orifice with tungsten hole in chuck. Be sure the pin in the side of the chuck points towards the rear and away from gas orifice of nozzle.

Step 3 - Using a pre-pointed tungsten, insert the tungsten through gas orifice of nozzle into tungsten hole on the side of the chuck.

Step 4 - Turn the tungsten and glass nozzle clockwise in unison, slowly until the chuck tightens up on the tungsten leaving the desired tungsten stick-out. Tighten snug avoid pressing tungsten against side of glass nozzle orifice.

Step 5 - Position glass nozzle orifice so that the tungsten is centered in nozzle orifice.

Tungsten Removal

Step 1 - Reverse Step 4, noted above, until the tungsten is loose and can be removed from the chuck.