

Cooling System

PARTS DIAGRAM

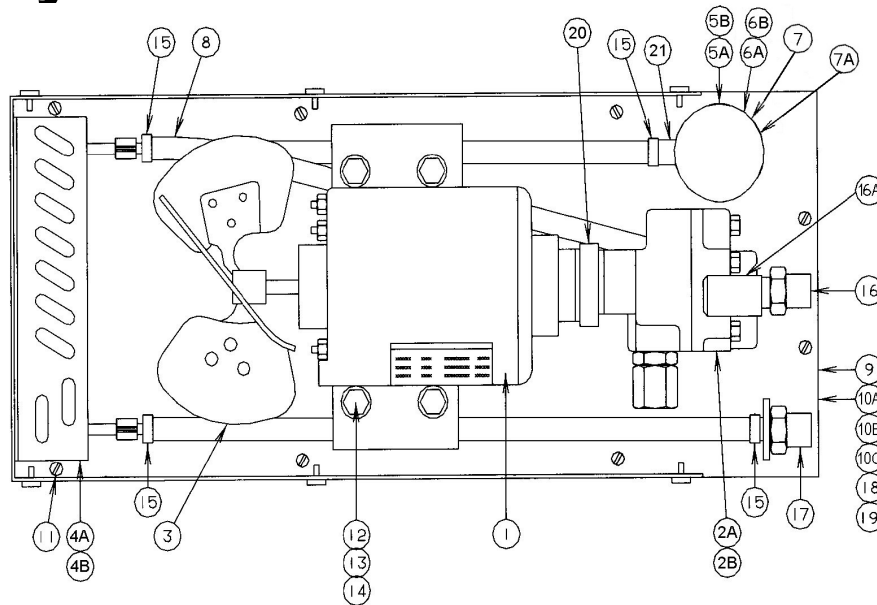

ITEM	PART NO.	DESCRIPTION
1	C 3000	Electric Motor 1/3 HP 115/230V-50/60 Hz
2A	C 1110	Gear Pump - Oberdorfer (Optional)
2B	C 102RP-V	Vane Pump - WeldTec® (Standard)
N/S	C 11969	Gear Pump Repair Kit
3	C 3075	Fan
4A	C 0900-2	Radiator Coil Unit C25, C35
4B	C 0900-3	Radiator Coil Unit C45
5A	C 1502-1	Fill Port Cap (Push On Cap)
6A	C 1502	Fill Port (Push On Cap Port)
7A	C 1502-2	Cap Retaining O-ring (Push On Cap)
5B	C 1503-1	Fill Port Cap (Screw On Cap)
6B	C 1503	Fill Port (Screw On Cap Port)
7	C 1503-5	Fill Port Mounting O-ring (Both)
8	C 0904	Hose, 3/8 I.D. typ.
9	C 0901-1	Top Plate
10A	C 0905-1	Stainless Steel Tank C25
10B	C 0905-3	Stainless Steel Tank C35
10C	C 0905-2	Stainless Steel Tank C45
11	C 1000	Sheet Metal Screw
12	C 1001	Hex Bolt
13	C 1003	Flat Washer
14	C 1004	Nut
15	C 0903	Stainless Steel Hose Clamp
16	C 1005	Water Adapter
16A	C 1005A	3/8 Street Elbow 90°
17	C 1002	Hose Nipple
18	C 1006	Tank Gasket
19	C 1007	Tank Feet Pads (4 Pack)
20	C 3003	Clamp (Gear Or Vane Pump)
21	C 1502-3	Nylon Hose Nipple
N/S	C 1012	Plastic Parts Storage Box (C35 Only)
N/S	C 1008	Strainer - Pick Up Hose
N/S	C 1010	Power Cord and Plug 115V-60Hz
N/S	C 0902	Stainless Steel Cover
N/S	C 1011	Hose Barb - 3/8
N/S	C 3007	Coupling Key (Gear Pump)
N/S	C 3008	Coupling Key (Vane Pump)
N/S	C 0902-1	Plastic Grill

N/S - Not Shown

SPECIFICATIONS

Pump Specifications and Capacity:

Factory pressure setting 50 PSI, adjustable 2-100 PSI.
Built-in bypass to tank (gear pump only).

Output: 1.7 gallons per minute @ 50 PSI.

Dimensions: C25 18" L x 9 1/4" W x 12 1/2" H.
C35 18" L x 9 1/4" W x 14" H.
C45 18" L x 9 1/4" W x 16" H.

Dry Weight: C25 Net 31 lbs.
C35 Net 33 lbs.
C45 Net 35 lbs.

Torch/gun connections:

Standard: 5/8-18 LH water adapter.

Model Data:

MODEL	MOTOR INPUT VOLTAGE	AMPERES INPUT FULL LOAD	PHASE	FREQUENCY (HZ)	COOLANT TANK CAPACITY
C25	115V	5.6	Single	50/60	2.0 gals
C35	115V	5.6	Single	50/60	3.0 gals
C45	115V	5.6	Single	50/60	4.0 gals

TEC WELDING PRODUCTS, INC.

P.O. Box 1870 • San Marcos, CA 92079 • Phone 760-747-3700
www.tectorch.com www.weldtec.com

REVISION H