

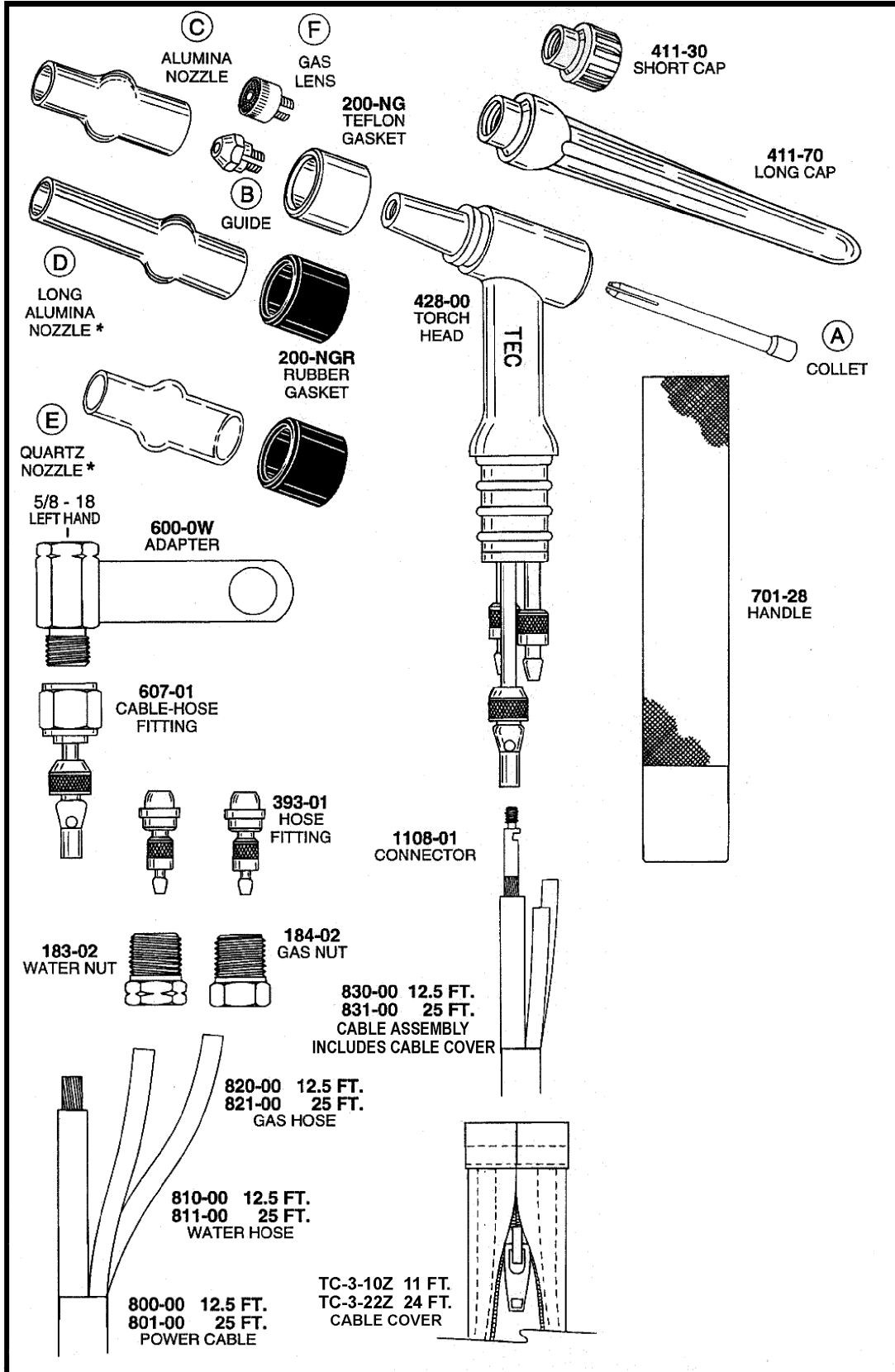

350 AMPS • WATER COOLED



(A) COLLETS		
965-01	1/16	1,6
966-01	3/32	2,4
967-01	1/8	3,2
968-01	5/32	4,0
(B) GUIDES		
961-51	1/16	1,6
961-61	3/32	2,4
961-71	1/8	3,2
961-81	5/32	4,0
(C) ALUMINA NOZZLES		
130-00	#4	1/4
131-00	#5	5/16
132-00	#6	3/8
133-00	#7	7/16
134-00	#8	1/2
136-00	#10	5/8
(D) LONG ALUMINA NOZZLES*		
130-07	#4L	1/4
131-07	#5L	5/16
132-07	#6L	3/8
(LONG NOZZLES 2-1/2 lg.)		
(E) QUARTZ NOZZLES (GLASS - VYCOR)*		
152-00	#6	3/8
(F) GAS LENS GUIDES		
950-51	1/16	1,6
950-61	3/32	2,4
950-71	1/8	3,2

TEC WELDING PRODUCTS, INC.

P.O. Box 1870 San Marcos, CA 92079

(760) 747-3700

*Requires 200-NGR Gasket